



45 Greenfields Gardens, Shrewsbury, SY1 2RN

3 bedroom town house—£259,000 Leasehold

45 Greenfields Gardens, Shrewsbury, SY1 2RN

Coopergreenpooks.co.uk

£259,000 Leasehold—3 bedroom town house

sales@cgpooks.co.uk

This very spacious and well designed 3 storey town house, benefits from a private driveway and integral garage, whilst being located in a quiet and well situated modern development, just 5 minutes from the town centre.

KEY FEATURES

- Entrance hall with built in storage and cloakroom.
- Ground floor 3rd bedroom/home office and separate utility room which also provides access to the rear garden.
- Staircase from hall to first floor landing where there is a good-sized living room with wood effect flooring and windows to front. There is also an open plan kitchen/dining room with fitted units and appliances.
- On the second floor there are 2 further large double bedrooms, with either an en-suite bath or shower room.
- Double glazed windows and gas fired central heating.
- Private driveway providing parking and access to an integral single garage.
- Lawned southwest facing rear garden with paved pathway.
- Quiet and popular residential area in a great location, from which there is a pathway and cycle path directly to the town centre and railway station.

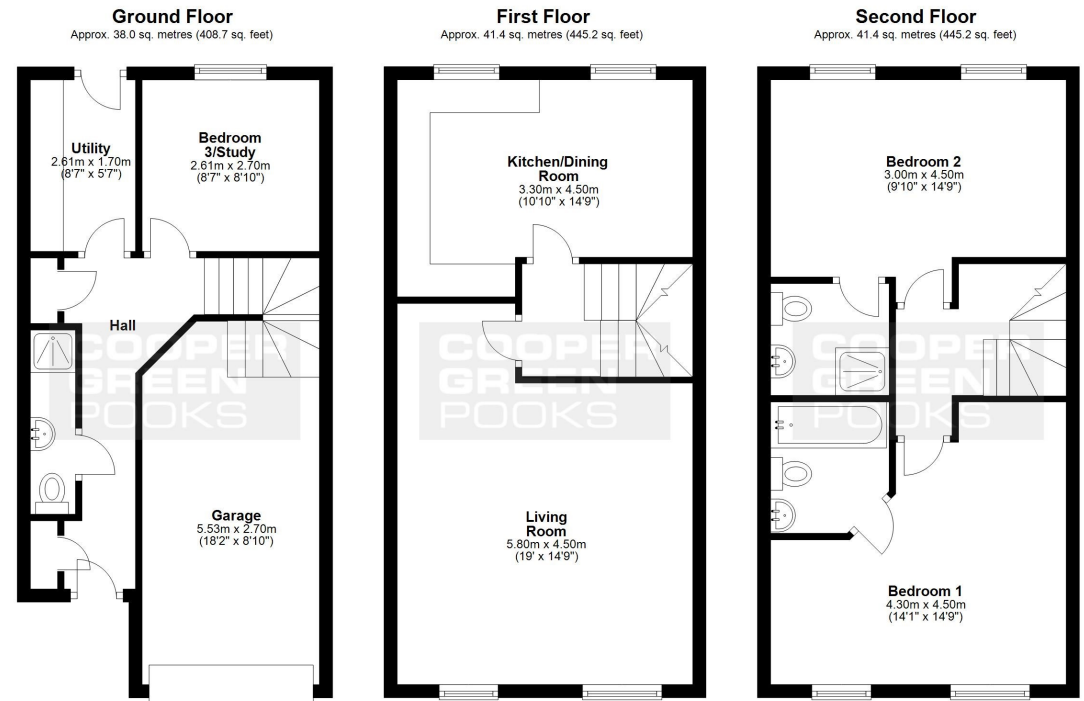

Total area: approx. 120.7 sq. metres (1299.0 sq. feet)

We accept no responsibility for any mistake or inaccuracy contained within the floorplan. The floorplan is provided as a guide only and should be taken as an illustration only. The measurements, contents and positioning are approximations only and provided as a guidance tool and not an exact replication of the property.
Plan produced using PlanUp.

Cooper Green Pooks
3 Barker Street
Shrewsbury
SY1 1QF

www.cgpooks.co.uk
sales@cgpooks.co.uk







45 Greenfields Gardens, Shrewsbury, SY1 2RN

£259,000 Leasehold—3 bedroom town house

sales@cgpooks.co.uk

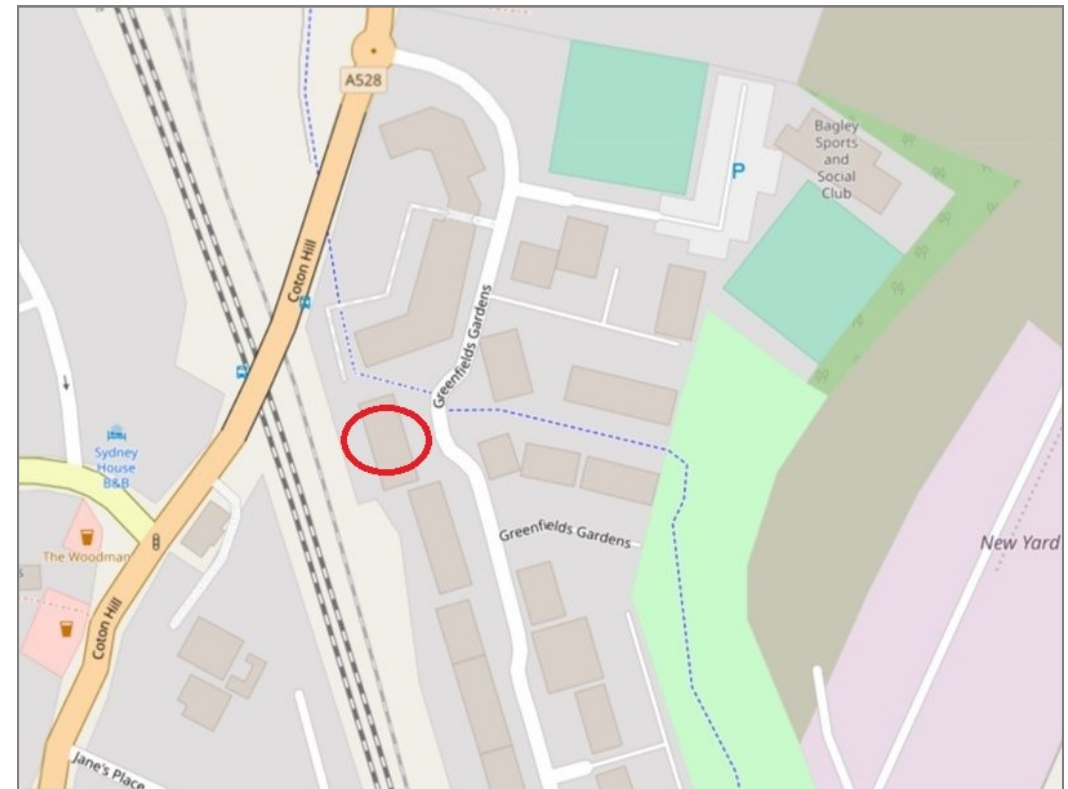

Tenure	Leasehold
Lease	155 years from April 2007
Service Charge	£405.00 PA
Local Authority	Shropshire Council
Council Tax	Band C
EPC Band	Band C
Services	All mains services connected

Expert mortgage advice available
3 Barker St, Shrewsbury SY1 1QF
Cooper Green Pooks
01743 276666



Your home may be repossessed if you do not keep up repayments on your mortgage.
There may be a fee for mortgage advice. The actual amount you pay will depend upon your circumstances. The fee is up to 1% but a typical fee is 0.3% of the amount borrowed.

45 Greenfields Gardens, Shrewsbury, SY1 2RN

Coopergreenpooks.co.uk

£259,000 Leasehold—3 bedroom town house

sales@cgpooks.co.uk

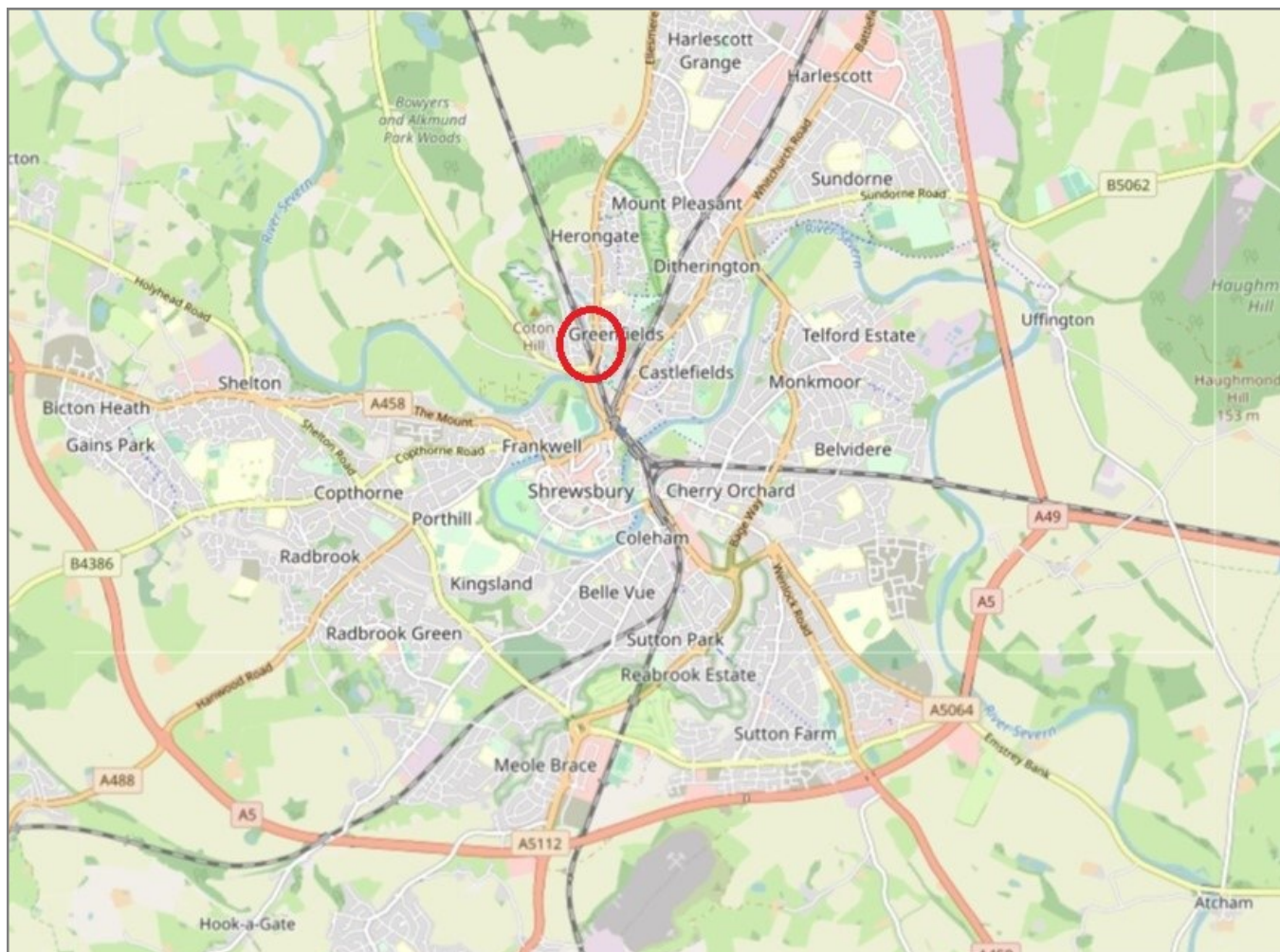

IMPORTANT NOTICE: Cooper Green Pooks for themselves and for the lessors or vendors of this property whose agents they are give notice that: 1 No appliances, services or service installations have been tested and no warranty as to suitability or serviceability is implied. Any prospective purchaser or lessee is advised to obtain verification from their surveyor or solicitor. 2. The particulars are set out as a general outline only for the guidance of the intended purchasers or lessees and do not constitute, nor constitute part of, an offer or contract. 3. All descriptions, reference to condition and necessary permissions for use and occupation and other details are given in good faith and are believed to be correct but any intending purchasers or lessees should not rely on them as statements or representation of fact but satisfy themselves by inspection or otherwise as to the correctness of each of them. 4. No person in the employment of Cooper Green Pooks has any authority to make or give any representation or warranty whatsoever in relation to this property. 5. All rentals and prices are quoted exclusive of Stamp Duty, legal and surveyors fees and any other associated purchasers or lessees costs. 6. Floor plans are indicative only and should not be relied on. 7. The plan showing the boundary of the property is indicative only and has not been checked against the legal title so should not be relied on. 8. All dimensions, floor areas and site areas are only approximate and should not be relied on. Dimensions are generally maximum room dimension.